

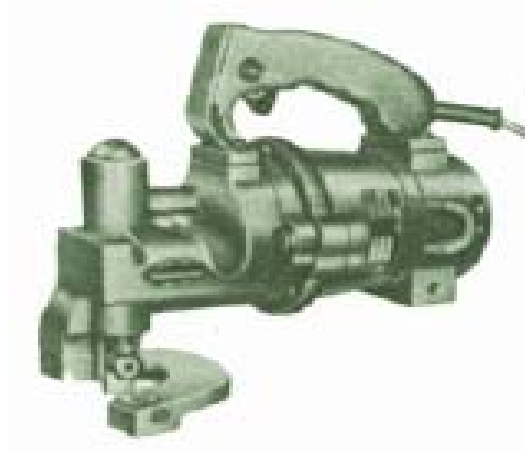

## PORTABLE ELECTRIC SHEARS



Portable electric shearing machine type EN3 used for shearing various materials upto a guage of 3 mm (1/8") and with tensile strength upto 45 ks./ sq. mm. Suitable for operation on universal AC/ DC 220 volts, single phase, 50 cycle electric supply having nominal input 600 watts. Approx. net weight 6.8 Kg.

### **Extra Accessories**

Extra Blade available per set

Extra Carbon Brush per piece.